

## Differential Pressure By-pass Valve

© Copyright 2022 Caleffi

519 Series

### Revit Content Instructions Guide

<b>Manufacturer &amp; Product:</b>	Caleffi 519 Differential Pressure By-pass Valve
<b>Files:</b>	<i>Differential_Pressure_Valve-Caleffi-519_Series.rfa</i>
<b>Type Catalogs:</b>	<i>Differential_Pressure_Valve-Caleffi-519_Series.txt</i>
<b>Rendering file:</b>	Not Applicable
<b>Schedule file:</b>	Not Applicable

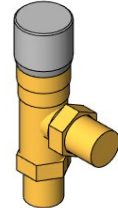

The 0BCaleffi 519 Differential Pressure By-pass Valve includes variations as follows:

1. Sizes include ¾ in., 1 in. and 1.25 in.
2. Connection types include Press, FNPT, MNPT and Sweat

### Instance Properties

Here is a curated list of notable parameters for the Revit user within the Caleffi 519 Differential Pressure By-pass Valve family.

Graphics	
Isometric Single Lines (default)	This controls the visibility of 2D symbol in elevation view
Mechanical - Flow	
Design Flow Rate (default)	This tells you the flow that this component is reading in the system.
Flow Warning (default)	This tells you a warning if the flow rate exceeds the maximum allowable.
Mechanical - Loads	
Differential Pressure (default)	Specify the differential pressure in psi

### Type Properties

Here is a curated list of notable parameters for the Revit user within the Caleffi 519 Differential Pressure By-pass Valve families.

Identity Data	
Assembly Code	D2090800
Contact URL*	<a href="http://www.caleffi.com/usa/en-us/contacts/contact-us">http://www.caleffi.com/usa/en-us/contacts/contact-us</a>
Copyright*	©Caleffi North America
Cost	
Description	Differential Pressure By-pass Valve
Family Version*	1
Keynote	
Manufacturer	Caleffi North America, Inc.
Model	519502A
Product Page URL*	<a href="https://www.caleffi.com/usa/en-us/catalogue/differential-pressure-pass-valve-519502a">https://www.caleffi.com/usa/en-us/catalogue/differential-pressure-pass-valve-519502a</a>
Type Comments	
Type Image	
Series*	519 Series
URL	<a href="https://www.caleffi.com/usa/en-us">https://www.caleffi.com/usa/en-us</a>

Half-tone text in the property tables indicates that the value is locked from editing.

\*Indicates Shared Parameter and can be scheduled

# Rendering

Note: Standard Caleffi materials are imported. These may be modified, but please ensure that the modification selection matches an actual manufacturer supplied option.

## Loading and Placing into the Project

To work with the Caleffi 519 Differential Pressure By-pass Valve in Revit, a family with all types loaded is provided. Navigate to the Insert Tab > Load Family button on the Revit ribbon to load the family.

Please ensure that the visibility settings within the project are modified to have the Piping category visible.

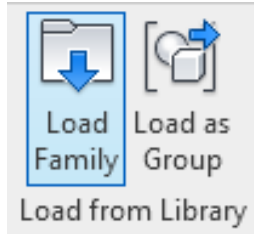

Figure 1 - Insert Tab > Load Family

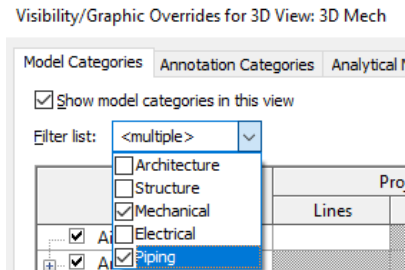

Figure 2 - Visibility/Graphic Overrides

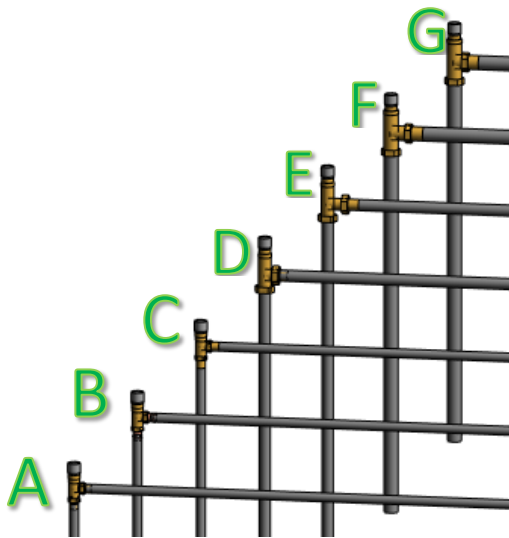

Figure 3 - OBCaleffi 519 Differential Pressure By-pass Valve

### Caleffi 519 Differential Pressure By-pass Valve with

- A. 0.75 in. Sweat Connection
- B. 0.75 in. Press Connection
- C. 0.75 in. FNPT Connection
- D. 1 in. Sweat connection
- E. 1 in. MNPT connection
- F. 1.25 in. FNPT Inlet, MNPT Outlet Connection (519700A)
- G. 1.25 in. FNPT Inlet, Sweat Outlet Connection (519709A)

**Instructions for connecting OBCaleffi 519 Differential Pressure By-pass Valve:** Place the family in project environment. In any elevation view, drag one of the connector points on the family to the connector or pipe-end part of the system where the family needs to be connected.

## Project Behavior

One way to place a Caleffi 519 Differential Pressure By-pass Valve is to go to the Systems Tab on the Revit ribbon and navigate to the Component button with 'Place a Component' fly-out selected.

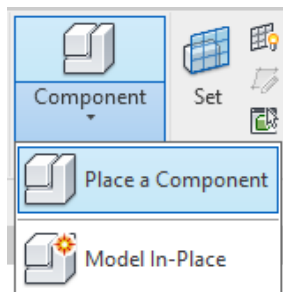

Figure 4 - Systems Tab > Component > Place a Component

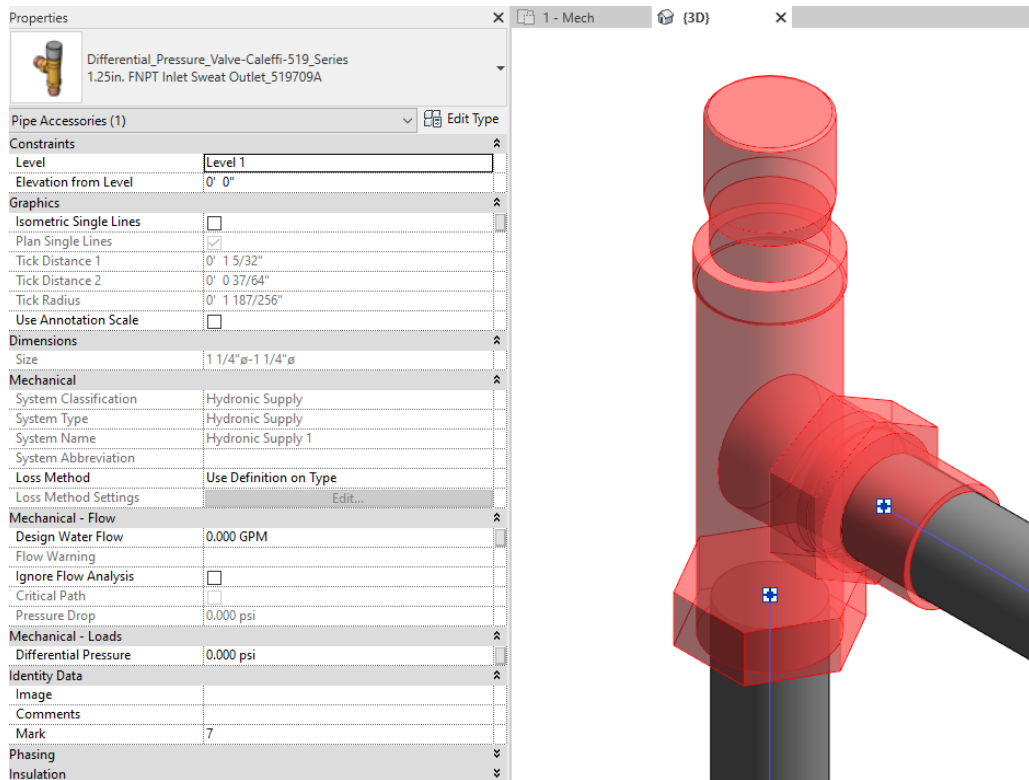

Figure 5 – The Caleffi 519 Differential Pressure By-pass Valve family can be found under pipe accessories in the project browser and placed directly onto pipe of the same size. It will then read flows and consider pressure drop in the system.

## Schedule Creation

Within the type and instance properties dialogues, the Revit user will find useful information for scheduling purposes such as Type, Part Description, Part Number/Model, Family Version, Manufacturer, Series, & Product Page URL. The resulting Pipe Accessories schedule in your project will show counts/quantities of the Caleffi 519 Differential Pressure By-pass Valve as well as separate quantities/counts of any separately purchased accessory products that do not come in box with the Caleffi 519 Differential Pressure By-pass Valve.