

Union Y-strainers

© Copyright 2022 Caleffi

128 Series

Revit Content Instructions Guide

Manufacturer & Product: Caleffi Union Y-Strainer 128 Series
Files: Union-Y_Strainer-Caleffi-128.rfa
Type Catalogs: Union-Y_Strainer-Caleffi-128.txt
Rendering file: Not Applicable
Schedule file: Not Applicable

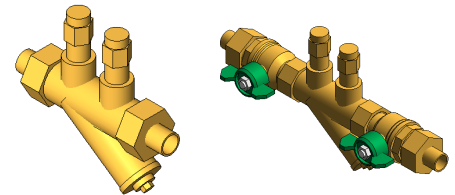

The 128 Series Union Y-Strainer, complete with two(2) PT ports and blowdown port, family contain the following main variations or types:

- Sizes 0.5 in., 0.75 in. and 1 in.
- Connection types MNPT, Press, Sweat, PEX Crimp, PEX Expansion

Instance Properties

Here is a curated list of notable parameters for the Revit user within the Caleffi Union Y-Strainer 128 Series family.

Construction	
► Isolation Valve on Inlet (default)	This controls visibility of the isolation valve on the inlet.
► Isolation Valve on Inlet Stem Extension (default)	This controls visibility of the isolation valve stem extension on the inlet.
► Isolation Valve on Outlet (default)	This controls visibility of the isolation valve on the outlet.
► Isolation Valve on Outlet Stem Extension (default)	This controls visibility of the isolation valve stem extension on the outlet.
Graphics	
Isometric Single Lines (default)	This controls the visibility of the 2D symbol in Elevation Views
Plan Single Lines (default)	This tells you if the 2D symbol is visible in Plan View
Mechanical – Flow	
Design Flow Rate (default)	This tells you the flow that this component is reading in the system.
Flow Warning (default)	This tells you a warning if the flow rate falls outside the allowable minimum/maximum
Mechanical – Loads	
Pressure Drop Feet of Water	Specify the pressure drop in feet of water.
System Pressure Drop	This tells you the system pressure drop.

Type Properties

Here is a curated list of notable parameters for the Revit user in the Caleffi Union Y-Strainer 128 Series family.

Materials	
Body Material	Metal - Caleffi - Brass
Fitting Material	Metal - Caleffi – Brass, Metal - Caleffi - Copper
Identity Data	
Assembly Code	D2090800
Contact URL*	https://www.caleffi.com/usa/en-us/contacts/contact-us
Copyright*	©Caleffi North America
Cost	
Description	Low-lead union Y-strainer
Family Version*	1
Keynote	
Manufacturer	Caleffi North America, Inc.
Model	128741000
Product Page URL*	https://www.caleffi.com/usa/en-us/catalogue/union-y-strainer-npt-128741000
Type Comments	
Type Image	
Series*	128 Series

Standards*	NSF/ANSI/CAN 372; S.3874; Vermont Act 193; Maryland's Lead Free Law; Reduction of Lead in Drinking Water Act - California Health and Safety Code 116875
URL	http://www.caleffi.com/usa/en-us

Half-tone text in the property tables indicates that the value is locked from editing.

*Indicates Shared Parameter and can be scheduled

Rendering

Note: Standard Caleffi materials are imported. These may be modified, but please ensure that the modification selection matches an actual manufacturer supplied option.

Loading and Placing into the Project

To work with the Caleffi Union Y-Strainer 128 Series in Revit, families and type catalogs where applicable are provided. Navigate to the Insert Tab > Load Family button on the Revit ribbon to load the family. Be sure the type catalog (.txt) file is located in the same folder as the family you are loading.

Please ensure that the visibility settings within the project are modified to have the Piping category visible.



Figure 1 - Insert Tab > Load Family

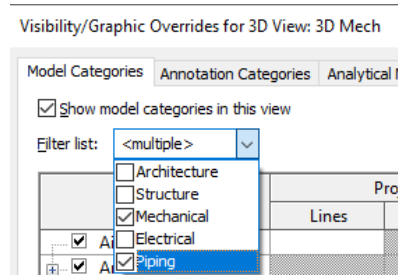

Figure 2 - Visibility/Graphic Overrides

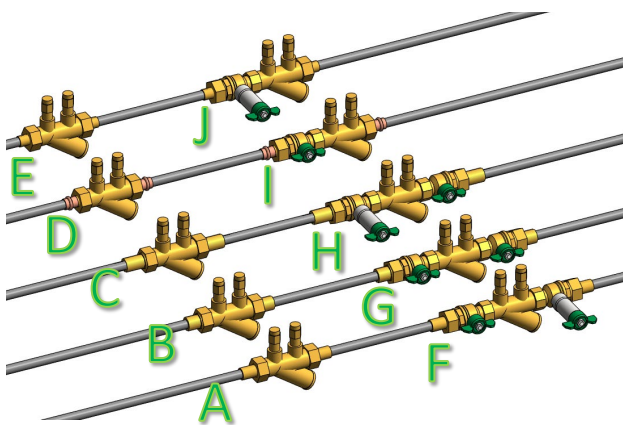

Figure 3 - OBCaleffi Union Y-Strainer 128 Series

- A. 128 Series Union Y-Strainer with MNPT tailpieces
- B. 128 Series Union Y-Strainer with PEX Crimp tailpieces
- C. 128 Series Union Y-Strainer with PEX Expansion tailpieces
- D. 128 Series Union Y-Strainer with Press tailpieces
- E. 128 Series Union Y-Strainer with Sweat tailpieces
- F. 128 Series Union Y-Strainer with MNPT tailpieces with 290030 valve on inlet and outlet (with stem extension)
- G. 128 Series Union Y-Strainer with PEX Crimp tailpieces with 290030 valve on inlet and outlet
- H. 128 Series Union Y-Strainer with PEX Expansion tailpieces with 290030 valve on inlet (with stem extension) and outlet
- I. 128 Series Union Y-Strainer with Press tailpieces with 290030 valve on inlet
- J. 128 Series Union Y-Strainer with Sweat tailpieces with 290030 valve on inlet with stem extension

Project Behavior

One way to place a Caleffi Union Y-Strainer 128 Series is to go to the Systems Tab on the Revit ribbon and navigate to the Component button with Place a component fly-out selected.

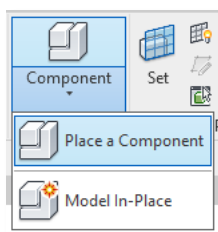

Figure 4 - Systems Tab > Component > Place a Component

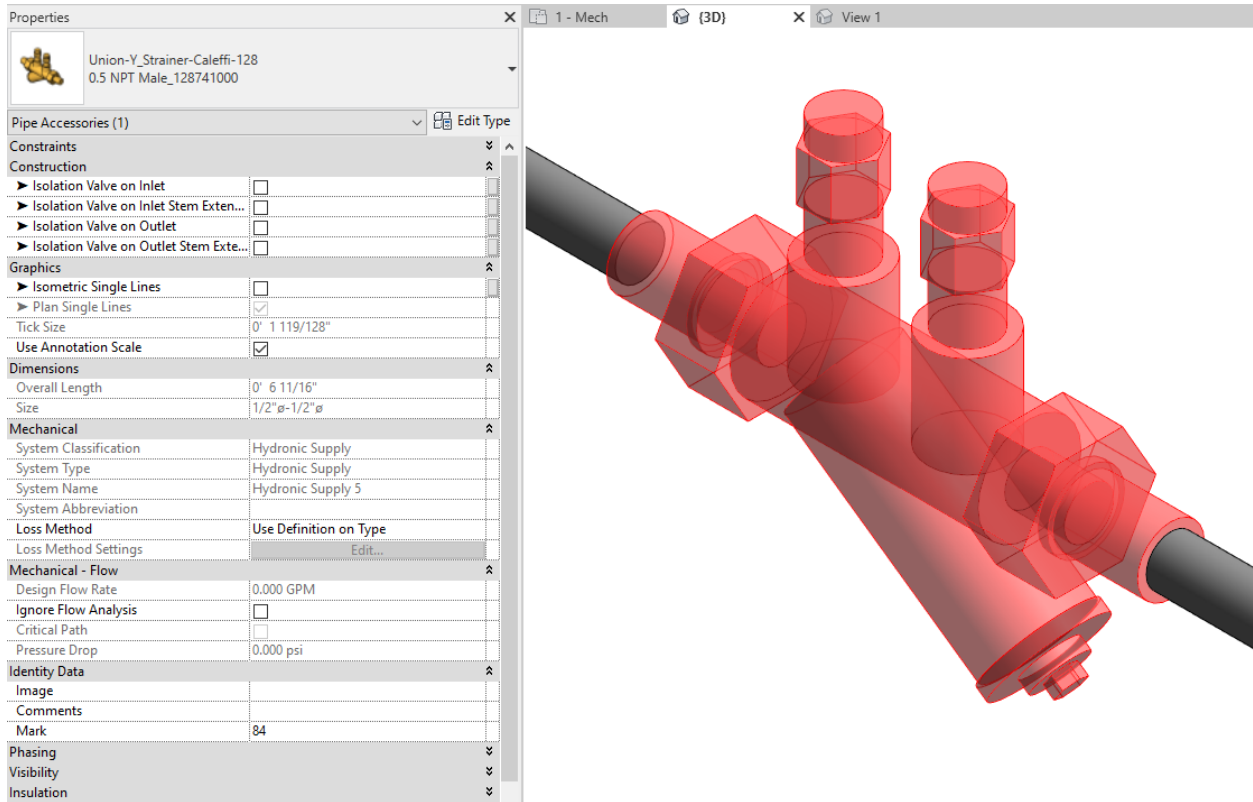

Figure 5 – The Caleffi Union Y-Strainer 128 Series families can be found under pipe accessories in the project browser and placed directly onto pipe of the same size. It will then read flows and consider pressure drop in the system.

Schedule Creation

Within the type and instance properties dialogues, the Revit user will find useful information for scheduling purposes such as Type, Part Description, Part Number/Model, Family Version, Manufacturer, Series, & Product Page URL. The resulting Pipe Accessories schedule in your project will show counts/quantities of the Caleffi Union Y-Strainer 128 Series as well as separate quantities/counts of any separately purchased accessory products that do not come in box with the Caleffi Union Y-Strainer 128 Series.