

## 676 Zone Valve with 200 Thermostatic Control Head

© Copyright 2022 Caleffi

676 Series

### Revit Content Instructions Guide

<b>Manufacturer &amp; Product:</b>	Caleffi 676 Zone Valve complete with 200 Thermostatic Control Head
<b>Files:</b>	<i>Thermoelectric_Zone_Valve-Caleffi-676_Body_200_Control_Head.rfa</i>
<b>Type Catalogs:</b>	Not Applicable
<b>Rendering file:</b>	Not Applicable
<b>Schedule file:</b>	Not Applicable

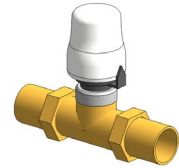

This family contains the following main variations or types:

- Sizes include 0.75in and 1 in with Sweat connection type

### Instance Properties

Here is a curated list of notable parameters for the Revit user within the Caleffi 676 Zone Valve complete with 200 Thermostatic Control Head family.

Mechanical - Flow	
Design Flow Rate (default)	This tells you the flow that this component is reading in the system.
Mechanical - Loads	
System Pressure Drop (default)	Specify the pressure drop for this product

### Type Properties

Here is a curated list of notable parameters for the Revit user within the Caleffi 676 Zone Valve complete with 200 Thermostatic Control Head family.

Identity Data	
Assembly Code	D2090800
Contact URL*	<a href="http://www.caleffi.com/usa/en-us/contacts/contact-us">http://www.caleffi.com/usa/en-us/contacts/contact-us</a>
Copyright*	©Caleffi North America
Cost	
Description	Two-way zone valve body (676) with Thermostatic control head (200)
Version	1
Keynote	
Manufacturer	Caleffi North America, Inc.
Model	200 Control head + 676 Valve Body
Product Page URL*	<a href="https://www.caleffi.com/usa/en-us/catalogue/two-way-zone-valve-body-676000a">https://www.caleffi.com/usa/en-us/catalogue/two-way-zone-valve-body-676000a</a>
Type Comments	
Type Image	
Series*	676 Series
URL	<a href="https://www.caleffi.com/usa/en-us">https://www.caleffi.com/usa/en-us</a>

Half tone text in the property tables indicates that the value is locked from editing.

\*Indicates Shared Parameter and can be scheduled

## Rendering

Note: Standard Caleffi materials are imported. These may be modified, but please ensure that the modification selection matches an actual manufacturer supplied option.

## Loading and Placing into the Project

To work with the Caleffi 676 Zone Valve complete with 200 Thermostatic Control Head in Revit, a family with loaded types is. Navigate to the Insert Tab > Load Family button on the Revit ribbon to load the family.

Please ensure that the visibility settings within the project are modified to have the Piping category visible.

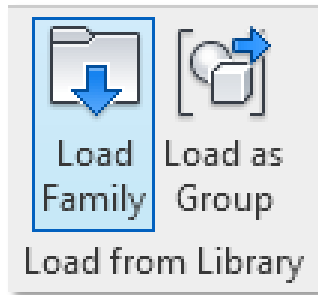

Figure 1 - Insert Tab > Load Family

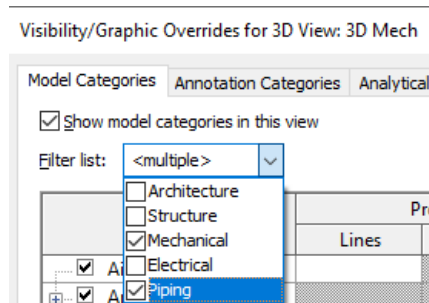

Figure 2 - Visibility/Graphic Overrides

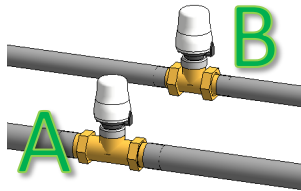

Figure 3 - Caleffi 676 Zone Valve complete

- A. Zone valve with 0.75in. Sweat Connection
- B. Zone valve with 1in. Sweat Connection

## Project Behavior

One way to place a Caleffi 676 Zone Valve complete with 200 Thermostatic Control Head is to go to the Systems Tab on the Revit ribbon and navigate to the Component button with Place a Component fly-out selected.

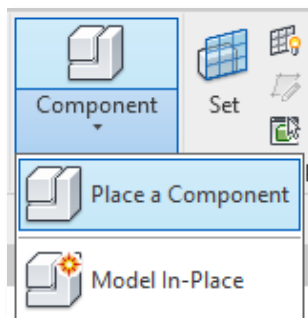

Figure 4 - Systems Tab > Component > Place a Component

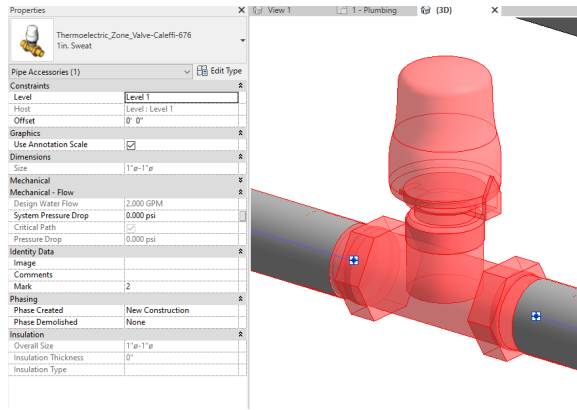

Figure 5 – The Caleffi 676 Zone Valve complete with 200 Thermostatic Control Head families can be found under pipe accessories in the project browser and placed directly onto pipe of the same size. It will then read flows and consider pressure drop in the system.

## Schedule Creation

Within the type and instance properties dialogues, the Revit user will find useful information for scheduling purposes such as Type, Part Description, Part Number/Model, Family Version, Manufacturer, Series, & Product Page URL. The resulting Pipe Accessories schedule in your project will show counts/quantities of the Caleffi 676 Zone Valve complete with 200 Thermostatic Control Head as well as separate quantities/counts of any separately purchased accessory products that do not come in box with the Caleffi 676 Zone Valve complete with 200 Thermostatic Control Head.