

PresCal™ HP Heavy-duty Piston-type Pressure Reducing Valve

© Copyright 2022 Caleffi

536A Series

Revit Content Instructions Guide

Manufacturer & Product:	Caleffi PresCal HP Heavy-duty Piston-type 536A Series Pressure Reducing Valve
Files:	<i>Pressure_Reducing_Valve-PresCalHP-Caleffi-536.rfa</i>
Type Catalogs:	<i>Pressure_Reducing_Valve-PresCalHP-Caleffi-536.txt</i>
Rendering file:	Not Applicable
Schedule file:	Not Applicable

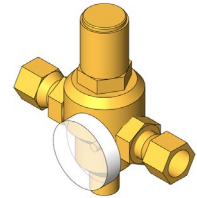

The Caleffi PresCal HP Heavy-duty Piston-type 536A Series Pressure Reducing Valve includes variations as follows:

- Sizes include ½ in., ¾ in., 1 in., 1.25 in., 1.5 in. and 2 in.
- Connection types include Press (except ½" size), NPT Female and Sweat

Instance Properties

Here is a curated list of notable parameters for the Revit user within the Caleffi PresCal HP Heavy-duty Piston-type 536A Series Pressure Reducing Valve family.

Graphics	
Isometric Single Lines (default)	This controls the visibility of 2D symbol in elevation view
Mechanical	
① 10 - 90psi Adjustment Range (default)	This activates the 10-90psi adjustment range
② 90 - 150psi Adjustment Range (default)	This indicates if 90-150psi adjustment range is selected.
Mechanical - Flow	
Design Flow Rate (default)	This tells you the flow that this component is reading in the system.
Flow Warning (default)	This tells you a warning if the flow rate exceeds the maximum allowable.
Mechanical - Loads	
Differential Pressure (default)	This controls the value of the differential pressure in psi
Identity Data	
Model Number (default)	This shows the model number based on the pressure adjustment range selection

Type Properties

Here is a curated list of notable parameters for the Revit user within the Caleffi PresCal HP Heavy-duty Piston-type 536A Series Pressure Reducing Valve families.

Identity Data	
Assembly Code	D2090800
Contact URL*	http://www.caleffi.com/usa/en-us/contacts/contact-us
Copyright*	©Caleffi North America
Cost	
Description	Heavy-duty piston-type pressure reducing valve
Family Version*	1
Keynote	
Manufacturer	Caleffi North America, Inc.
Model	536XXA
Product Page URL*	https://www.caleffi.com/usa/en-us/catalogue/prescaltm-hp-536043a-109
Type Comments	
Type Image	
Series*	536A Series

Half-tone text in the property tables indicates that the value is locked from editing.

*Indicates Shared Parameter and can be scheduled

Rendering

Note: Standard Caleffi materials are imported. These may be modified, but please ensure that the modification selection matches an actual manufacturer supplied option.

Loading and Placing into the Project

To work with the Caleffi PresCal HP Heavy-duty Piston-type 536A Series Pressure Reducing Valve in Revit, a family with all types loaded is provided. Navigate to the Insert Tab > Load Family button on the Revit ribbon to load the family.

Please ensure that the visibility settings within the project are modified to have the Piping category visible.

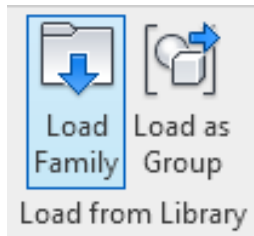

Figure 1 - Insert Tab > Load Family

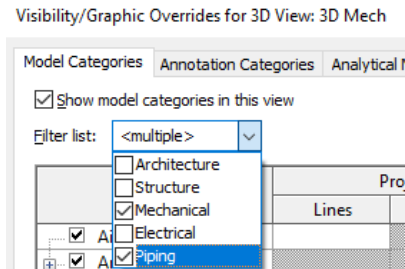
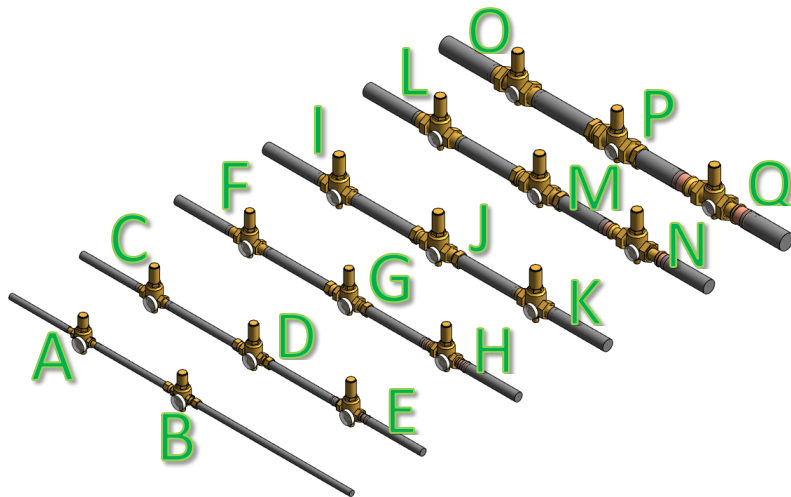

Figure 2 - Visibility/Graphic Overrides



- A. 0.5 in. Sweat Connection
- B. 0.5 in. NPT Female Connection
- C. 0.75 in. Sweat Connection
- D. 0.75 in. NPT Female Connection
- E. 0.75 in. Press Connection
- F. 1 in. Sweat Connection
- G. 1 in. NPT Female Connection
- H. 1 in. Press Connection
- I. 1.25 in. Sweat Connection
- J. 1.25 in. NPT Female Connection
- K. 1.25 in. Press Connection
- L. 1.5 in. Sweat Connection
- M. 1.5 in. NPT Female Connection
- N. 1.5 in. Press Connection
- O. 2 in. Sweat Connection
- P. 2 in. NPT Female Connection
- Q. 2 in. Press Connection

Figure 3 - Caleffi PresCal HP Heavy-duty Piston-type 536A Series Pressure Reducing Valve

Project Behavior

One way to place a Caleffi PresCal HP Heavy-duty Piston-type 536A Series Pressure Reducing Valve is to go to the Systems Tab on the Revit ribbon and navigate to the Component button with 'Place a Component' fly-out selected.

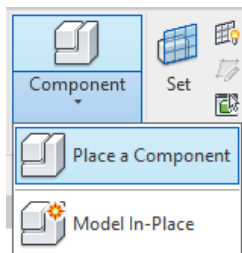

Figure 4 - Systems Tab > Component > Place a Component

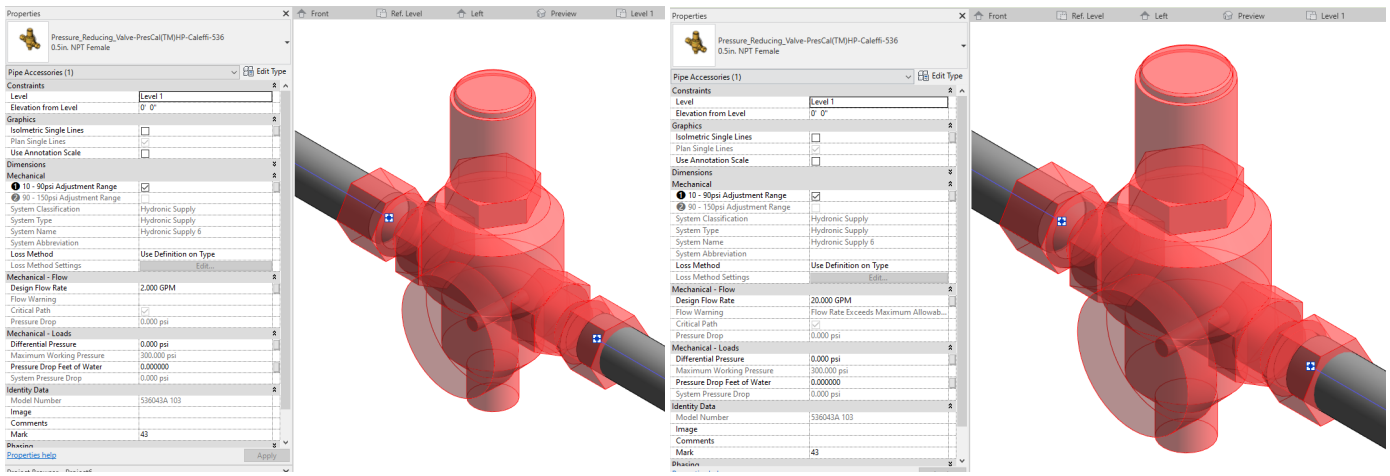

Figure 5 – The Caleffi PresCal HP Heavy-duty Piston-type 536A Series Pressure Reducing Valve family can be found under pipe accessories in the project browser and placed directly onto pipe of the same size. It will then read flows and consider pressure drop in the system. In the figure, a flow warning is shown when flow through the accessory exceeds the maximum allowable.

Schedule Creation

Within the type and instance properties dialogues, the Revit user will find useful information for scheduling purposes such as Type, Part Description, Part Number/Model, Family Version, Manufacturer, Series, & Product Page URL. The resulting Pipe Accessories schedule in your project will show counts/quantities of the Caleffi PresCal HP Heavy-duty Piston-type 536A Series Pressure Reducing Valve as well as separate quantities/counts of any separately purchased accessory products that do not come in box with the Caleffi PresCal HP Heavy-duty Piston-type 536A Series Pressure Reducing Valve.