

LEGIOMIX® Electronic Mixing Valve

© Copyright 2022 Caleffi

6000 Series

Revit Content Instructions Guide

Manufacturer & Product:	Caleffi 6000 Legiomix
Files:	<i>Electronic_Mixing_Valve-Legiomix-Caleffi-Brass-6000.rfa</i> <i>Electronic_Mixing_Valve-Legiomix-Caleffi-Brass-6000-Flanged.rfa</i>
Type Catalog:	<i>Electronic_Mixing_Valve-Legiomix-Caleffi-Brass-6000.txt</i> <i>Electronic_Mixing_Valve-Legiomix-Caleffi-Brass-6000-Flanged.txt</i>
Rendering file:	Not Applicable
Schedule file:	Not Applicable

These families contain the following main variations or types:

- 0.75in. MNPT_600054A
- 0.75in. Sweat_600059A
- 0.75in. Press_600056A
- 1in. MNPT_600064A 001
- 1in. Sweat_600069A 001
- 1in. Press_600066A 001
- 1in. MNPT_600064A
- 1in. Sweat_600069A
- 1in. Press_600066A
- 1.25in. MNPT_600074A
- 1.25in. Sweat_600079A
- 1.25in. Press_600076A
- 1.5in. MNPT_600084A
- 1.5in. Sweat_600089A
- 1.5in. Press_600086A
- 2in. MNPT_600094A
- 2in. Sweat_600099A
- 2in. Press_600096A
- 2.5in. Flange_600060A
- 3in. Flange_600080A

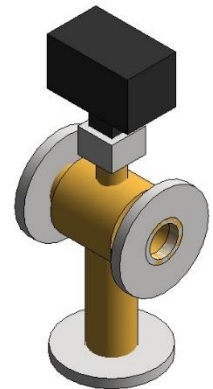

Instance Properties

Here is a curated list of notable parameters for the Revit user within the Caleffi 6000 Legiomix families.

Mechanical - Flow	
Design Flow Rate (default)	This tells you the flow that this component is reading in the system.
Flow Warning (default)	This tells you a warning if the flow rate exceeds the maximum allowable.
Mechanical - Loads	
Pressure Drop Feet of Water (default)	Specify the pressure drop in feet of water.
System Pressure Drop (default)	This tells you the system pressure drop.
Mechanical	
Cold Water Inlet Flow (default)	This tells you the cold water inlet flow that considers the Cold Water Percentage and Tempered Water Outlet Flow.
Cold Water Percentage (default)	This tells you the cold water percentage and considers the Hot Water Percentage.
Hot Water Inlet Flow (default)	This tells you the hot water inlet flow and considers the Tempered Water Outlet Flow and Hot Water Percentage.
Hot Water Percentage (default)	Specify the hot water percentage.
Tempered Water Outlet Flow (default)	Specify the tempered water outlet flow.

Type Properties

Here is a curated list of notable parameters for the Revit user within the Caleffi 6000 Legiomix families.

Materials	
Actuator Body Material	Plastic - Caleffi - Black
Body Material	Metal - Caleffi - Brass

Identity Data	
Assembly Code	D3040
Contact URL*	http://www.caleffi.com/usa/en-us/contacts/contact-us
Copyright*	©Caleffi North America
Cost	
Description	Electronic Mixing Valve with programmable thermal disinfection
Family Version*	1
Keynote	
Manufacturer	Caleffi North America, Inc.
Model	600096A
Product Page URL*	https://www.caleffi.com/usa/en-us/catalogue/legiomixr-electronic-mixing-valve-600064a
Type Comments	
Type Image	
Series*	6000 Series
Standards*	ASSE 1017/CSA B125.3, CSA Z317.1, NSF/ANSI/CAN 372
URL	https://www.caleffi.com/usa/en-us

Halftone text in the property tables indicates that the value is locked from editing.

*Indicates Shared Parameter and can be scheduled

Rendering

Note: Standard Caleffi materials are imported. These may be modified, but please ensure that the modification selection matches an actual manufacturer supplied option.

Loading and Placing into the Project

To work with the Caleffi 6000 Legiomix in Revit, multiple families and variations within type catalogs are provided. Navigate to the Insert Tab > Load Family button on the Revit ribbon to load the family. Be sure the type catalog (.txt) file is located in the same folder as the family you are loading.

Please ensure that the visibility settings within the project are modified to have the Piping category visible.

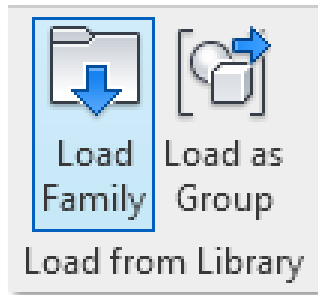

Figure 1 - Insert Tab > Load Family

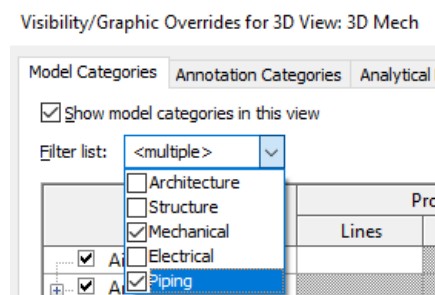

Figure 2 - Visibility/Graphic Overrides

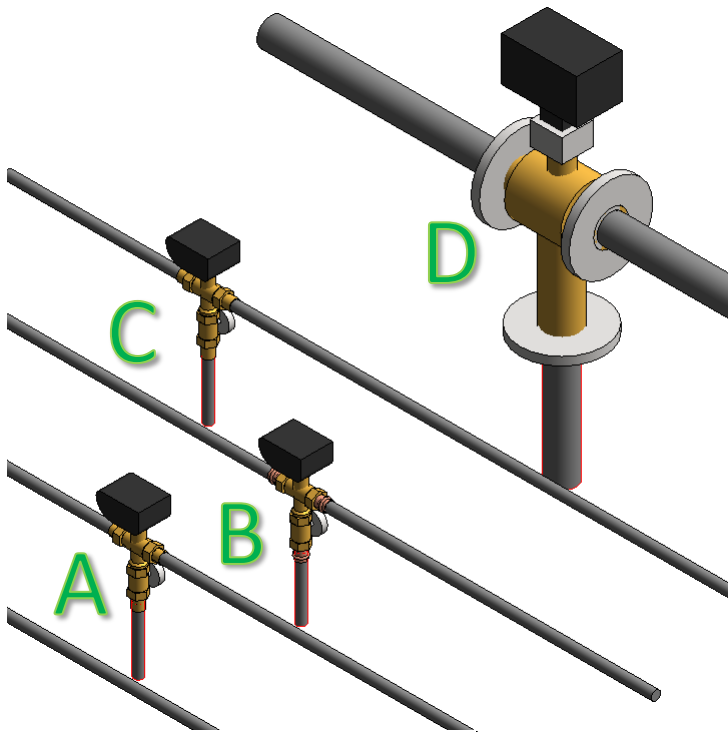

Figure 3 - Caleffi 6000 Legiomix

- A. Legiomix 6000 with Sweat tailpieces
- B. Legiomix 6000 with Press tailpieces
- C. Legiomix 6000 with MNPT tailpieces
- D. Legiomix 6000 with flanged connections

Project Behavior

One way to place a Caleffi 6000 Legiomix is to go to the Systems Tab on the Revit ribbon and navigate to the Component button with Place a Component fly-out selected.

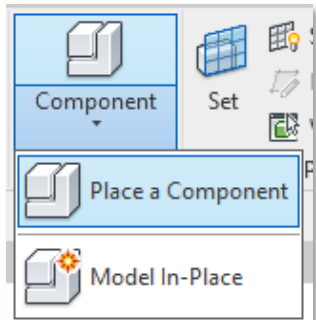

Figure 4 - Systems Tab > Component > Place a Component

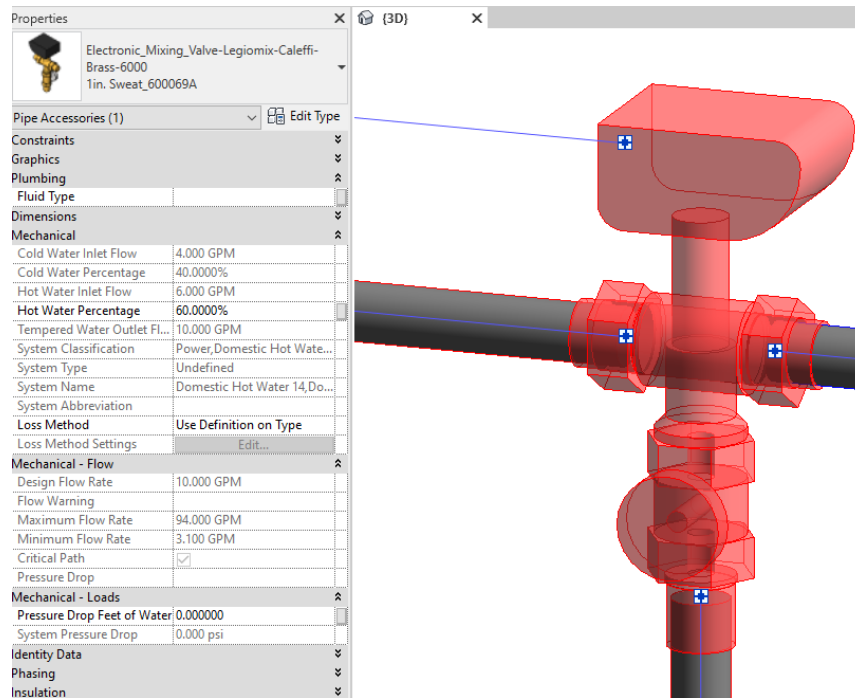

Figure 5 – The Caleffi 6000 Legiomix families can be found under pipe accessories in the project browser and placed directly onto pipe of the same size. It will then read flows and consider pressure drop in the system.

Schedule Creation

Within the type and instance properties dialogues, the Revit user will find useful information for scheduling purposes such as Type, Part Description, Part Number/Model, Family Version, Manufacturer, Series, & Product Page URL. The resulting Pipe Accessories schedule in your project will show counts/quantities of the Caleffi 6000 Legiomix as well as separate quantities/counts of any separately purchased accessory products that do not come in box with the Caleffi 6000 Legiomix.