



## Digital controller for solar thermal systems



### 257 series - SOLCAL 1

#### Function - Features

- designed for solar thermal systems
- practical to use with digital control and analog type settings
- program display with synoptic diagram
- up to three probes type Pt1000 may be connected
- display of operating status by means of Led
- management of eight different system configurations
- appliance management by means of two relay outputs
- relay manual management
- factory configured with max. safety temperature settings



## 257 series

### Technical specifications

#### Performance

Electric supply:	230 V ±6% - 50 Hz
Power consumption:	2 VA
Output signals:	2 relays (closure)
Maximum contact rating:	250 V (ac) - 5 A; in total max. 8 A
Ambient temperature range:	0-40°C
Protection class:	IP 40
Insulation class:	II

## Characteristic components

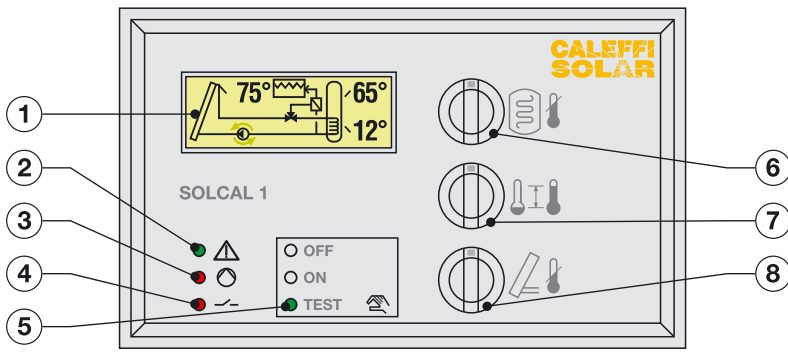

- 1) Display with function synoptic diagram
- 2) Probe or function error
- 3) Relay 1 ON
- 4) Relay 2 ON
- 5) Manual management of relay 1-2
- 6) Max. storage temperature
- 7)  $\Delta T$  Setting
- 8) Minimum temperature setting or circuit exchange

## Control programs

On the rear panel of the regulator there are 4 DIL switches. The position of these switches determines the type of program chosen.

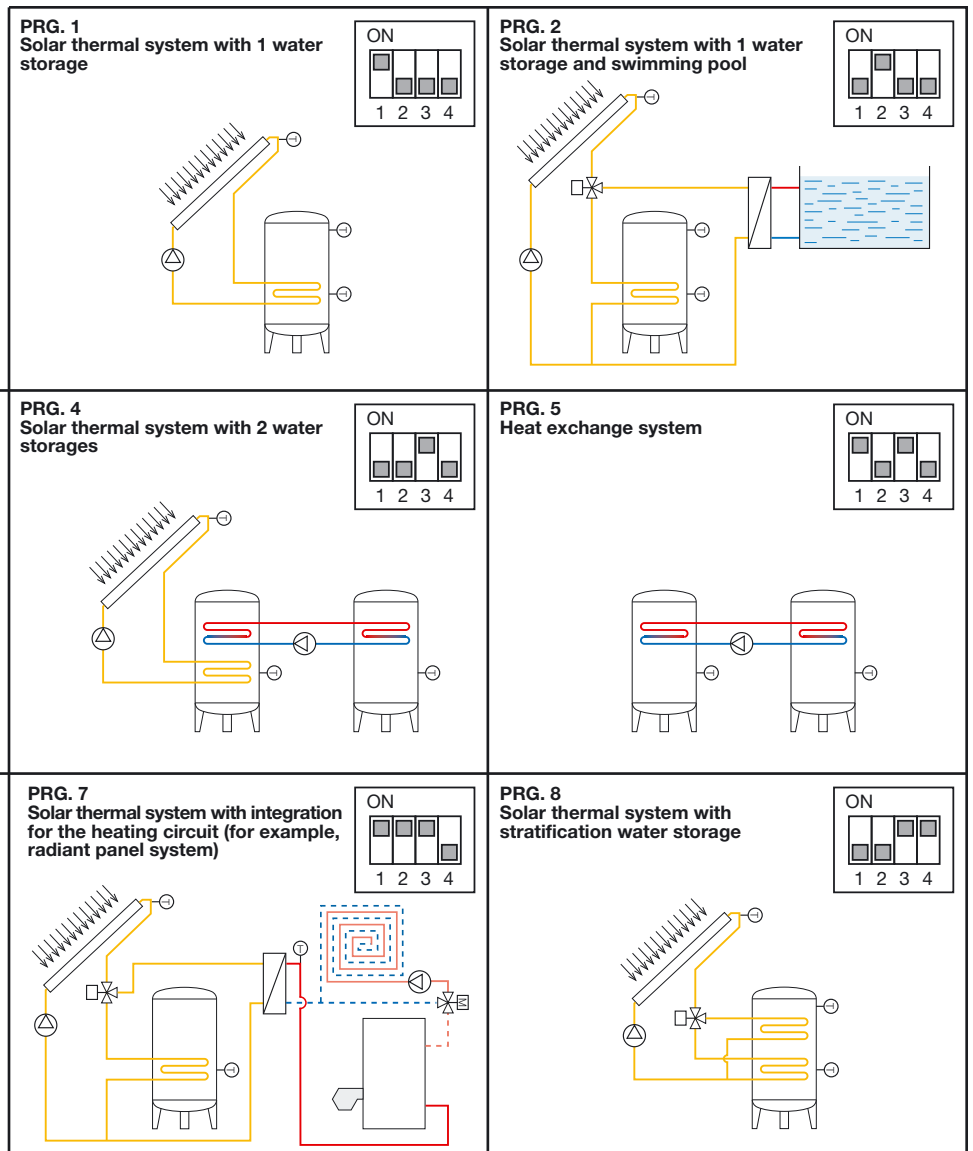

We reserve the right to make changes and improvements to the products and related data in this publication, at any time and without prior notice.

CALEFFI S.P.A. · I · 28010 FONTANETO D'AGOGNA (NO) · S.R. 229, N.25 · TEL. +39 0322 8491 R.A. · FAX +39 0322 863723

· www.caleffi.com · info@caleffi.com ·

© Copyright 2009 Caleffi