

Balancing valve with flow meter

132 series

Function - Features

- specific for accurately regulating the medium flow rate
- direct reading of the flow rate on the built-in flow meter with a magnetic movement gauge
- simplified commissioning, with no measuring instruments
- flow meter can be automatically shut off during normal operation
- flow rate gauge always clean because not in direct contact with the medium
- the valve can be fully open or closed
- complete with hot pre-formed shell insulation
- patent application No. MI2007A000703



Product range

132 series Balancing valve with flow meter.
 Sizes 1/2", 3/4", 1", 1 1/4", 1 1/2" and 2".



132 series

Reference documentation:  Tech. broch. 01149

Technical specifications

Performance

Medium:	water, glycol solutions
Max. percentage of glycol:	50%
Max. working pressure:	10 bar
Working temperature range:	-10–110°C
Flow rate range unit of measurement:	l/min
Accuracy:	±10%
Operating wrench:	1/2"–1 1/4" 9 mm 1 1/2"–2" 12 mm
Control stem rotation angle:	90°
Threaded connections:	1/2"–2" F

Flow rate ranges

Code	132402	132512	132522	132602	132702	132802	132902
Size	1/2"	3/4"	3/4"	1"	1 1/4"	1 1/2"	2"
Flow rates (l/min)	2–7	5–13	7–28	10–40	20–70	30–120	50–200

Insulation

Thickness:	10 mm
Density:	- inner part: 30 kg/m ³ - outer part: 50 kg/m ³
Thermal conductivity (DIN 52612):	- at 0°C: 0,038 W/(m·K) - at 40°C: 0,045 W/(m·K)
Coefficient of resistance to water vapour (DIN 52615):	> 1.300
Temperature range:	0–100°C
Reaction to fire (DIN 4102):	class B2

Complete opening and closing of the valve

Complete closing of the valve

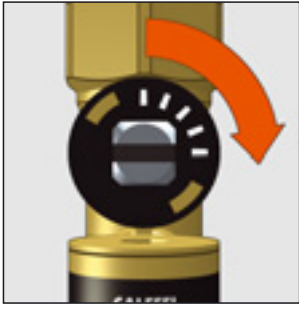

Complete opening of the valve

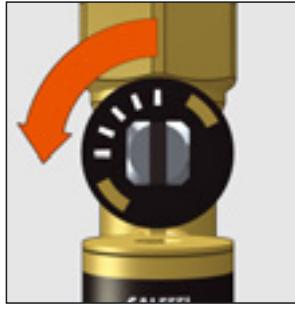

Flow rate adjustment

The flow rate is adjusted by carrying out the following operations:

A. With the aid of the indicator (1), mark the reference flow rate at which the valve has to be set.

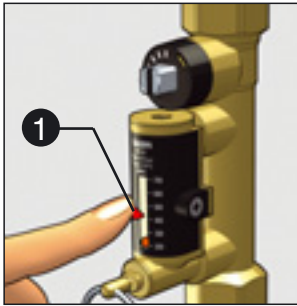

B. Use the ring (2) to open the obturator that shuts off the flow of medium in the flow meter (3) under normal operating conditions.

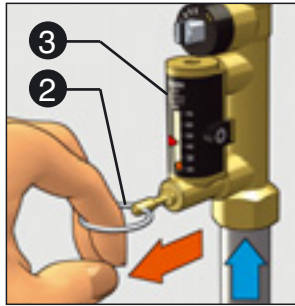

C. Keeping the obturator open, apply a wrench on the control stem of the valve (4) to adjust the flow rate. It is indicated by a metal ball (5) that runs inside a transparent guide (6) marked by a graduated scale in l/min.

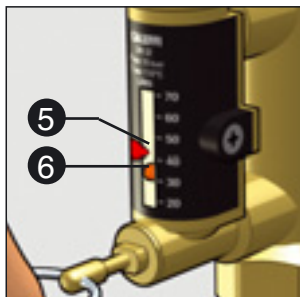
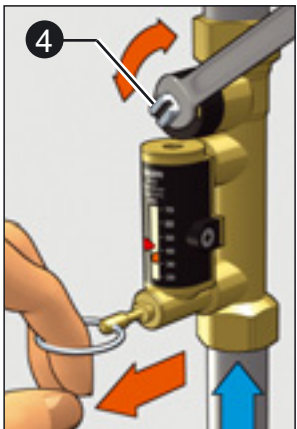

D. After completing the balancing, release the ring of the flow meter obturator that, thanks to an internal spring, will automatically go back into the closed position.

Insulation

The 132 series balancing valve is supplied complete with hot pre-formed insulation. This system ensures not only perfect thermal insulation, but also tightness to water vapour from the environment towards the inside. For these reasons, this type of insulation can also be used in chilled water circuits as it prevents condensation forming on the surface of the valve body.



Installation

The valve can be fitted on either vertical or horizontal pipes.

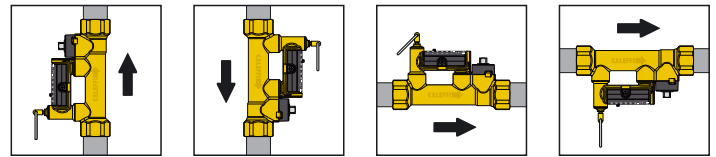

Application diagram

The balancing valve with the flow meter should preferably be installed on the circuit return pipe.

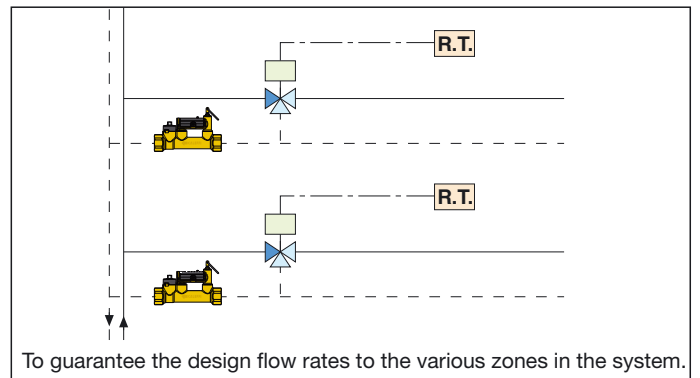
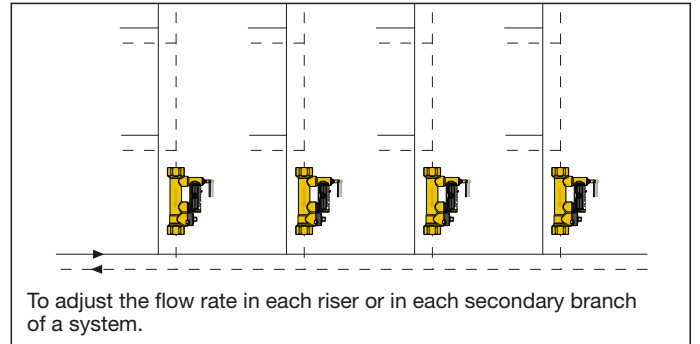

We reserve the right to make changes and improvements to the products and related data in this publication, at any time and without prior notice.